



JK HD ADJUSTABLE SPARE TIRE MOUNTING KIT

#4838130 Kit for 5 on 5" Wheels

#4838235 Kit for 5 on 5.5" Wheels

#4838188 Kit for 8 on 6.5" Wheels

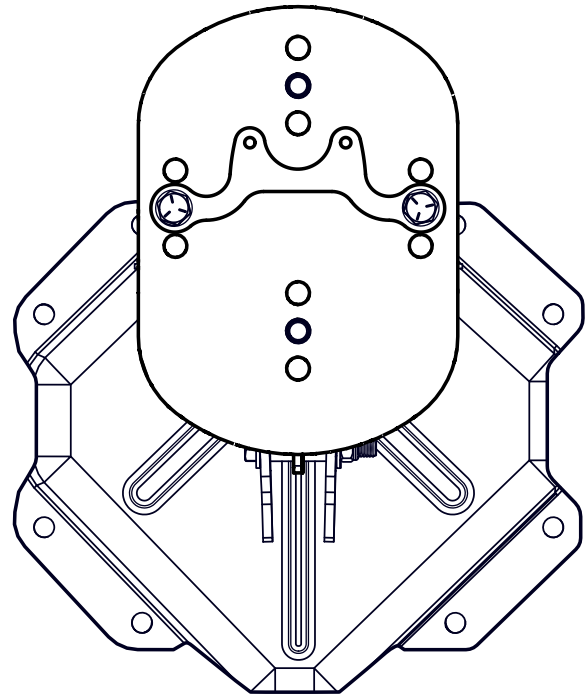
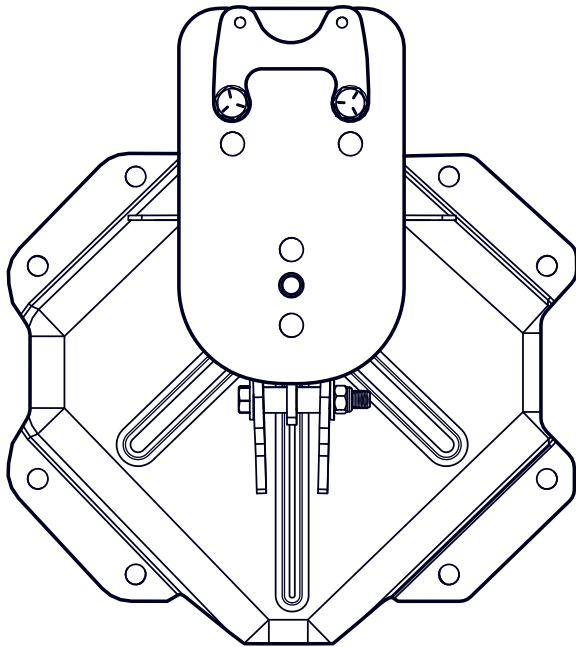

IMPORTANT NOTES:

Prior to beginning this install, or any installation, *read the instructions thoroughly* to familiarize yourself with the required steps. Evaluate if you are experienced and capable to personally perform these modifications. A factory service manual should be used in conjunction with these installation instructions.

This product will change the highway handling characteristics of your vehicle, exercise caution. After altering the suspension it is always advisable to have an alignment done by a competent 4 wheel drive shop or by an alignment shop that is experienced with lifted 4 wheel drive vehicles.

Refer to the parts list to ensure that all necessary components and hardware has been included. If any parts are missing please contact your local TeraFlex dealer for assistance.

If you are using the factory wheels, you will also need to use a wheel spacer in conjunction with this kit. Kit #1055005.

TOOLS NEEDED:

- Lug Wrench
- 13 mm socket
- 16 mm socket
- Ratchet
- Blue thread locking compound
- Cut off wheel and grinder or other method to cut factory third brake light

Maintenance Note:

After the first 300 miles re-torque all hardware and bolts.

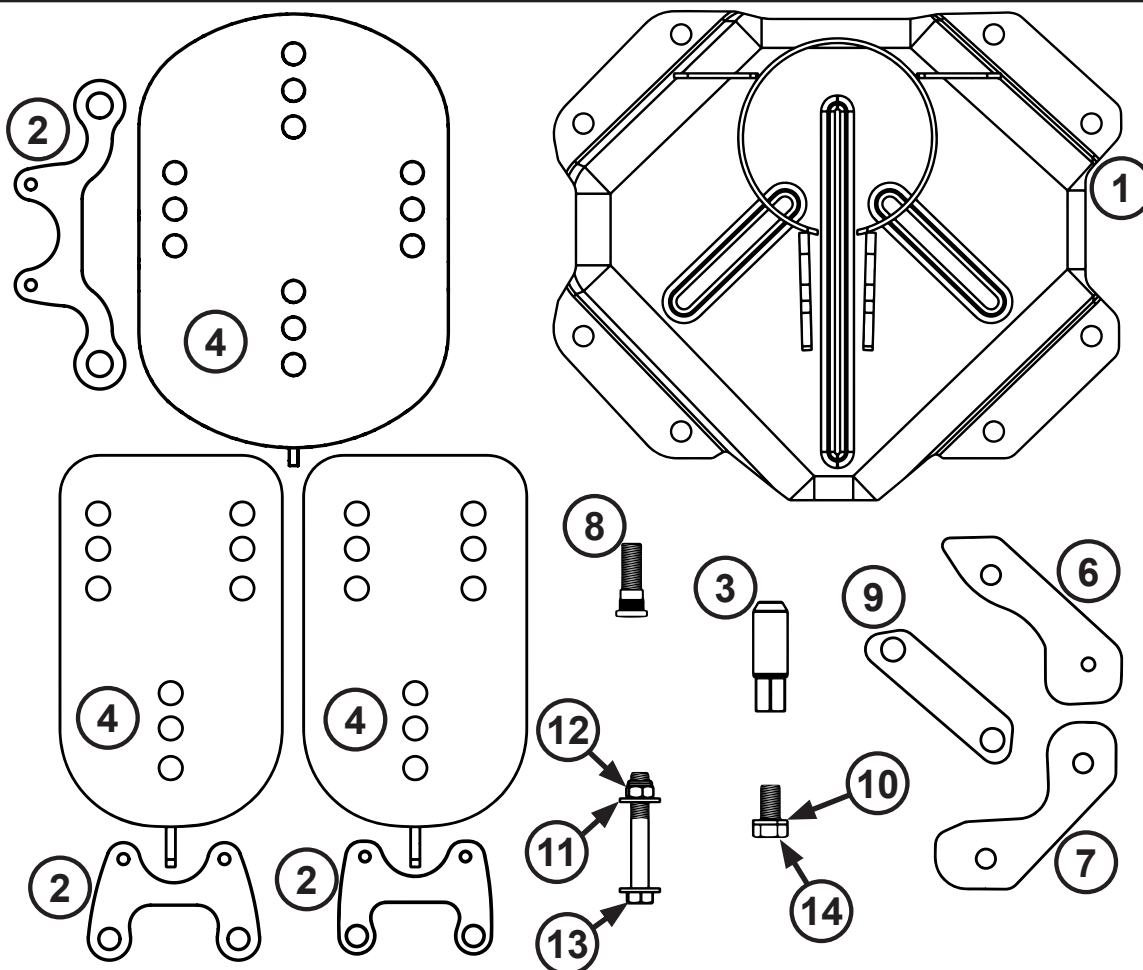

Item #	Part No.	Description	4838130 / 4838235 QTY	4838188 QTY
1	838184	Adjustable Tire Mount Base Plate and Tube Assembly, JK	1	1
2	838149 838150 838151	3rd Brake Light Mounting Plate, JK Tire Carrier	1	1
3	838128	Custom Lug Nut for Brake Light Mount with 1/2"-20 UNF	2	2
4	838117 838118 838188	Sliding Mount Plate Assembly, JK Tire Carrier Mount	1	1
5	838106	Adjustable Mount Anti-Rotation Bushing, JK Tire Carrier	2	2
6	838105	Upper Plate Spacer, JK Tire Carrier	1	1
7	838104	Lower Plate Spacer, JK Tire Carrier	1	1
8	610192	Wheel Stud 1/2"-20 UNF x 1.7" Long Zinc	3	4
9	610039	Spacer Plate Gaskets, JK Tire Carrier	4	4
10	351	Washer 1/2" Lock Washer Zinc	2	2
11	254	Washer M10 Flat with Zinc	4	4
12	253	Nut M10 x 1.5 Hex Head Stover Zinc	2	2
13	252	Bolt M10 x 1.5 x 70mm Long Hex Head Grade 10.9 Zinc	2	2
14	235	Bolt 1/2"-20 UNF x 1" Long Hex Head with Zinc	2	2

NOTE: The following instruction sheet details the installation of the Adjustable Oversize Wheel and Tire Mount on the tailgate as a stand alone tire mount, as well as in conjunction with the Cast Tailgate and Hinge Reinforcement Kit.

- 1** Remove existing spare tire and original spare tire bumpers from tailgate, if present.

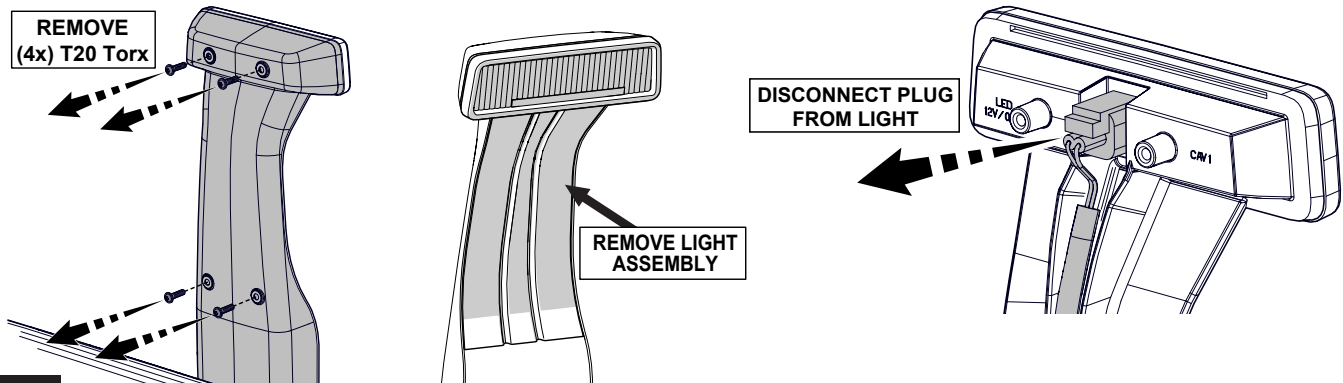

- 2** Remove light assembly from carrier housing.

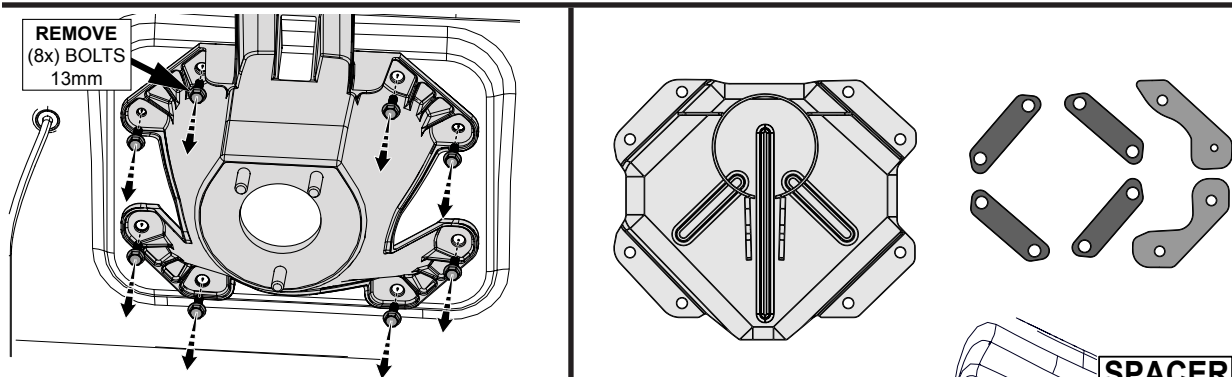

- 3** Skip forward to step 5 if installing with the cast hinge kit.

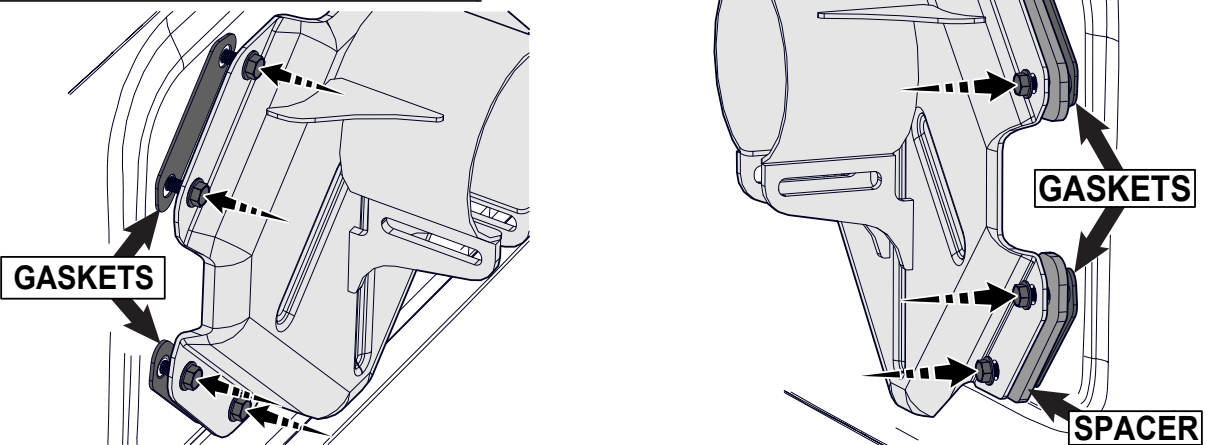

- 4** Apply thread locking compound to original bolts and install tire mount base as shown. Torque the 8 mounting bolts to 20 N-m (15 ft-lbs)

Steps 5 outline the installation of the adjustable tire mount base when installed inconjunction with the cast hinge (Part # 82214770).

Skip ahead to step 6 for tire mounting plate installation and adjustment.

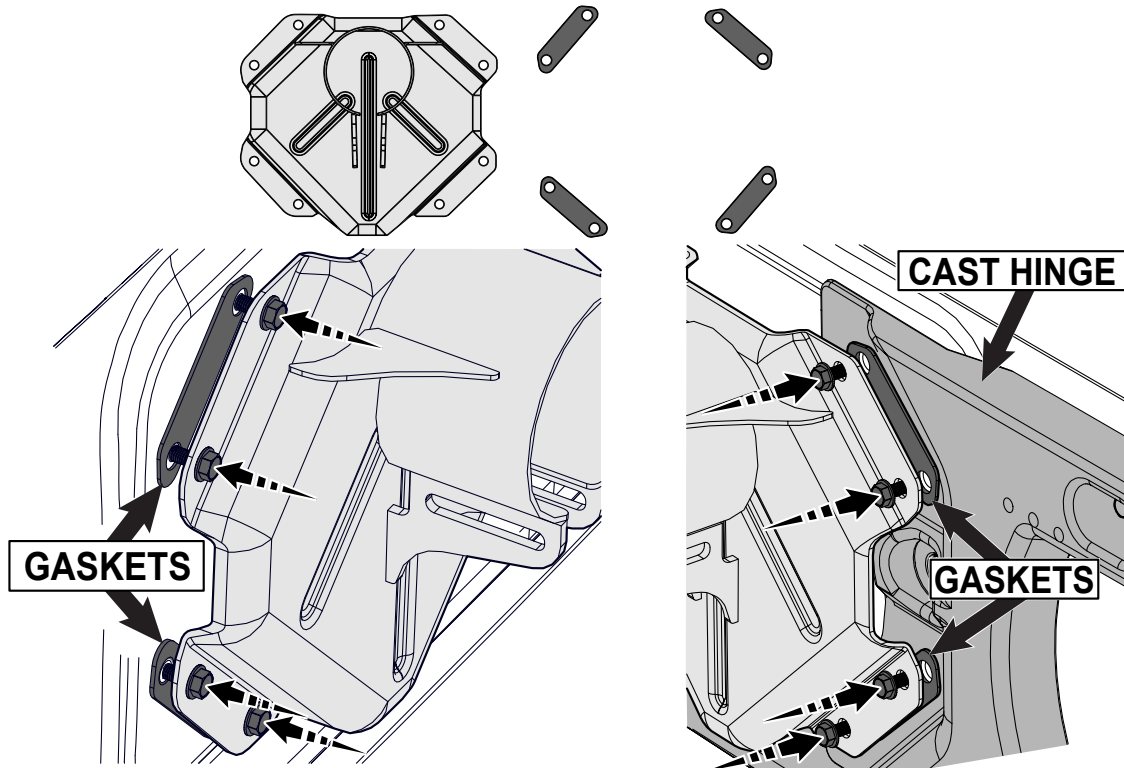

Place gaskets between tailgate and mount, apply thread locking compound and loosely install 4 of the original bolts

Place gaskets between 1 and mount, apply thread locking compound and loosely install remaining 4 original bolts

5

Torque the 8 mounting bolts to 20 N-m (15 ft-lbs)

LUG LOCATIONS FOR TIRE SIZE

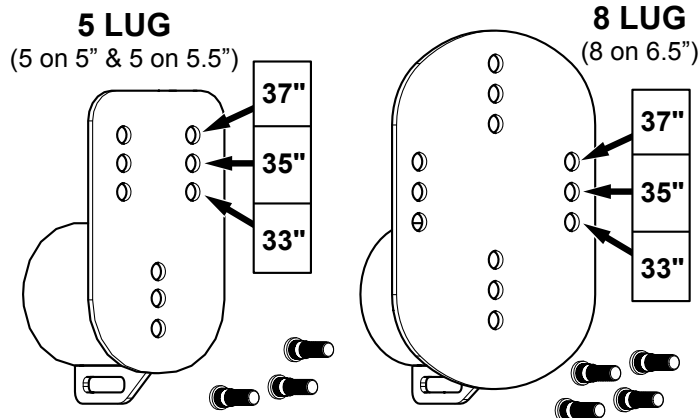

6

Press the included wheel studs into the appropriate set of holes for your tire size (3 wheel studs for 5 lug and 4 for 8 lug).

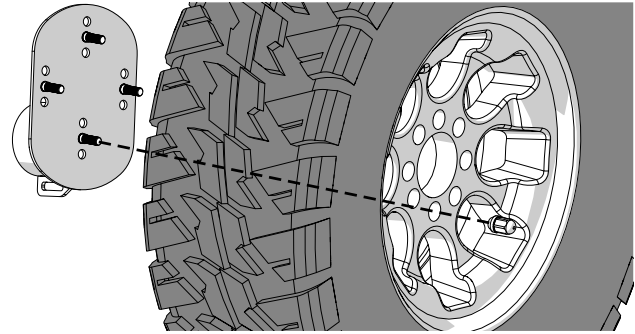
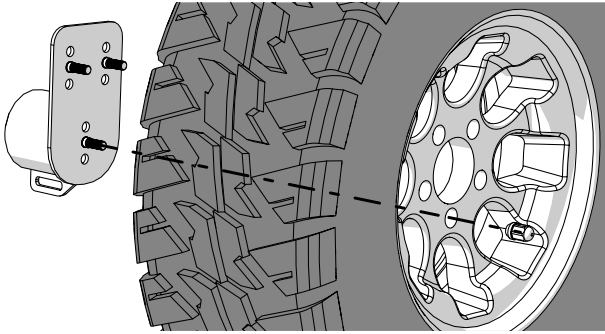

7

Attach the Mount Plate to the spare tire using 1 lug nut

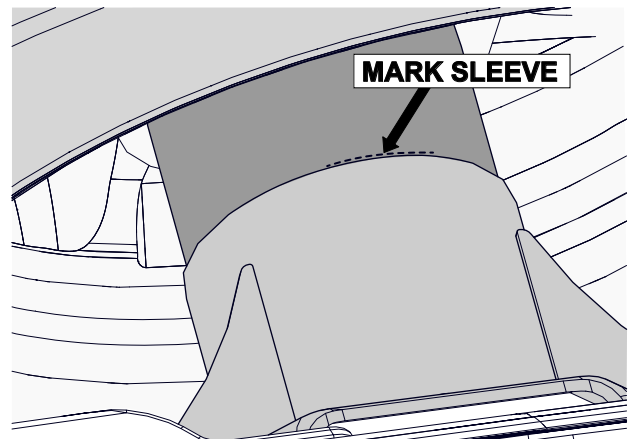
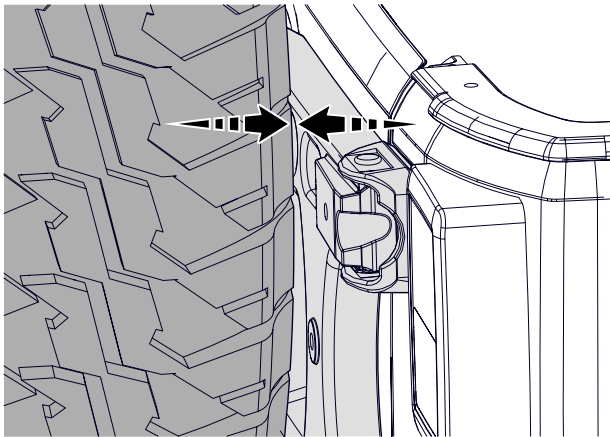

Slide the mount into the base on the tailgate. Push the tire firmly up against the cast hinge.

Mark a line on the mount where it meets the base.

Remove spare tire and mount assembly.

8

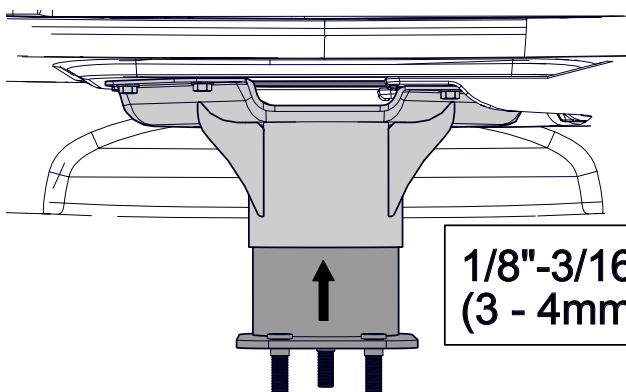

1/8"-3/16"
(3 - 4mm)

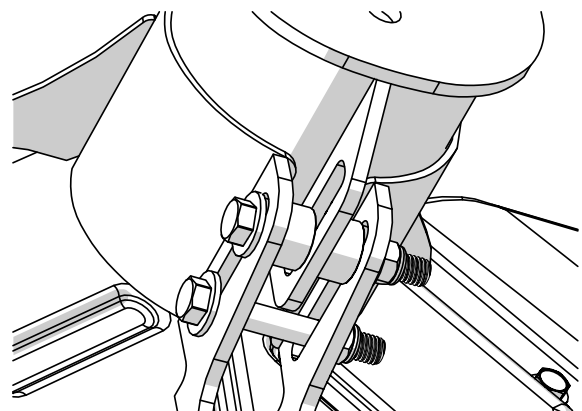

Remove the mount from the tire. Reinstall mount plate onto mount base.

Slide mount plate in 1/8" - 3/16" (3 - 4 mm) farther past line past marked reference line.

Install pinch bolts and spacers. Ensure at least 1 bolt is installed through slot on mount.

Torque bolts to 38 ft-lbs (51 N-m)

9

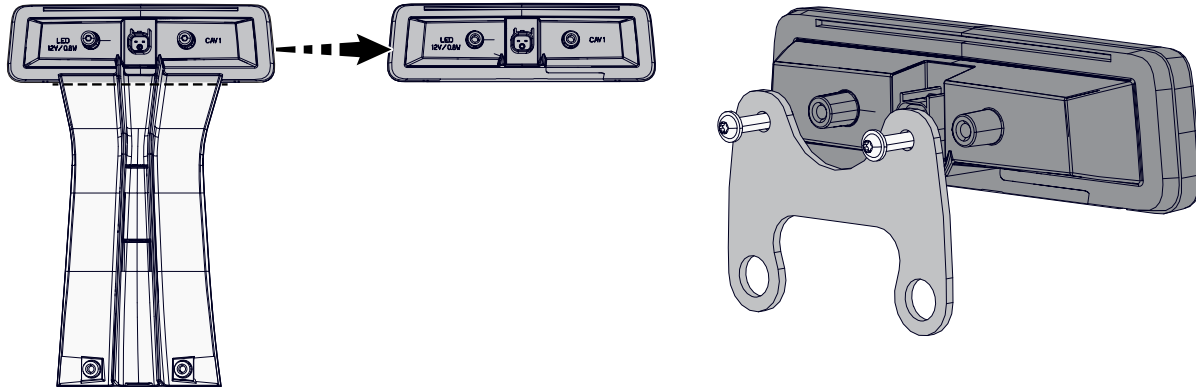

Cut factory third brake light along black line.

Use 2 original T20 Torx screws to mount the cut third brake light to bracket.

10

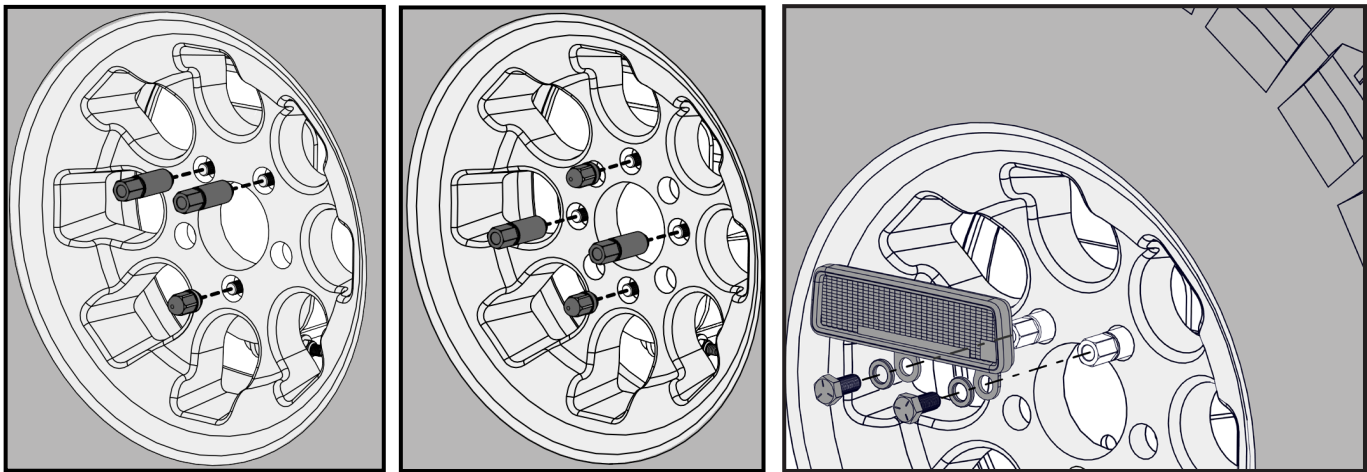

Install spare tire using the two included custom lug nuts as shown.

For the other lug(s) install the original(s) and torque to 65 ft-lbs (87 N-m)

11

Route brake light wiring through wheel, plug light in and torque bolts to 37 ft-lbs (50 N-m)

- Open and close tailgate to ensure proper function if cast hinge was installed.
- Ensure tire is **firmly** pressed against the cast hinge or against the factory tire bumpers on the tailgate if the cast hinge was not used
- Fold and place this instruction sheet in the vehicle glove box for future reference.
- For customer service questions, refer to your local Jeep dealership.

TERAFLEX

PRODUCT INFORMATION

MAINTENANCE INFORMATION:

It is the buyer's responsibility to have all suspension, drivetrain, steering, and other components checked for proper tightness and torque after the first 100 miles and every 3000 miles after that.

NOTICE TO INSTALLER:

The enclosed "Warning to Driver" sticker must be installed in the vehicle in driver's view. This sticker is to act as a constant safety reminder when operating the vehicle. It is your responsibility as the equipment installer to install the provided sticker and to forward the product instructions to the vehicle's owner for review. If a "Warning to Driver" sticker or product installation guide were not included in the kit, FREE replacement stickers and instructions are available by request. It is the installer's duty to ensure a safe and controllable vehicle after the modifications have been performed.

WARNING:

Neither the seller nor the manufacturer will be liable for any loss, damage, or injury directly or indirectly arising from the use of or inability to determine the use of these products. Before using, the user shall determine the suitability of the products for its intended use, and the user shall assume all responsibility and risk in connection therewith.

WARNING TO DRIVER:

This vehicle has been modified to enhance off road performance and has unique handling characteristics. Use in harsh environments can cause extreme stress on the components. Vehicle should be inspected after being off road to make sure that all the components are in working order and safe to travel on the highway. All fasteners should be checked so that they are at the correct torque specifications as the vibration and stresses from off roading may cause critical fasteners to work loose. Extra care should be taken to inspect the critical components, steering, and brake systems. During each oil change components such as arms, tie rod ends, etc should be greased and checked for excessive wear. Any worn components should be replaced. When returning to the pavement always set or restore tire air pressure to the factory recommendation and connect or engage any disabled sway bar mechanisms. Because of the higher center of gravity and larger tires, this vehicle handles and reacts differently than many passenger cars, both on and off road. You must drive it safely! Extreme care should be taken to prevent vehicle rollover or loss of control, which can result in serious injury or death. Avoid sudden sharp turns or abrupt maneuvers. Generally, braking performance and capabilities are decreased when significantly larger/heavier tires are used, especially when used in combination with transfer case low-range reduction kits. Take this into consideration while driving. Do not add, alter or fabricate any factory or aftermarket parts to increase vehicle height over the intended height of the TeraFlex product purchased. Mixing component brand is not recommended. TeraFlex Inc. will not be responsible for any altered product or any improper installation or use of our products. We will be happy to answer any questions concerning the design, function, and correct use of our products. It is ultimately the buyer's responsibility to have all bolts/nuts checked for tightness after the first 100 miles and then every 3000 miles. Wheel alignment, steering system, suspension and drive line systems must be inspected by a qualified professional mechanic at least every 3000 miles.

TERAFLEX PRODUCT WARRANTY:

TeraFlex Inc. warrants TeraFlex Suspension products to the original retail purchaser to be free of defects in material and workmanship for as long as the original purchaser owns the vehicle on which products were originally installed.

Failure to complete regular maintenance (grease every 3000 miles) on TeraFlex FlexArms will void this warranty. All other conditions of the standard TeraFlex product warranty apply.

All TeraLow products are covered by the TeraFlex two (2) year warranty to be free of defects in material and workmanship for two years from date purchased.

TeraFlex axles are covered by a 12-month warranty to be free of defects in materials and workmanship.

This warranty does not cover or include product finish, improperly installed or applied products, improperly maintained products, products or components used for racing or competition or damage due to abuse or neglect, products that fail due to the use of larger tire and wheel combinations.

All returns must be accompanied by an original invoice. It is the customer's responsibility to remove the product from the vehicle. Shipping charges are the responsibility of the customer. TeraFlex Inc. will pay the return freight if the product meets the terms of warranty.

This warranty is for the replacement or repair of defective TeraFlex products only and does not include freight charges, labor charges for removal of or installation of TeraFlex or related products or components, costs incurred due to down time of the vehicle, or lost profits due to vehicle down time.

A returned goods authorization number (RGA#) must accompany any returned products. For more information please contact a TeraFlex customer service representative.

COPYRIGHT

©Copyright 2014. All rights reserved, TeraFlex Inc. Reproduction of this catalog and/or any of its contents without written permission is strictly prohibited.

TeraFlex® is a registered trademark of TeraFlex Inc. All trade names and logos including but not limited to TeraFlex, FlexArms, RockGuard, Monster, and LCG are protected by law and duplication of trade names and/or logos are strictly prohibited.

TeraFlex Inc. reserves the right to update, discontinue, redesign, modify finish, part number or component build parts if deemed necessary without written notice. TeraFlex Inc., and any associated dealers are not responsible for misprints or typographical errors that may have inadvertently been made within this instruction sheet.

Jeep® and the Jeep® grill are registered trademarks of Fiat Chrysler Automobiles N.V., and have no affiliation with TeraFlex Inc.

TERAFLEX, Inc.
5680 West Dannon Way
West Jordan, UT. 84081
Phone/801.713.3314
Fax/801.713.2313
www.teraflex.com